

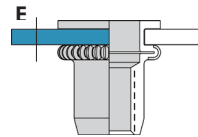

# GROOVED LARGE HEAD NUT TUERCA RANURADA CABEZA ANCHA

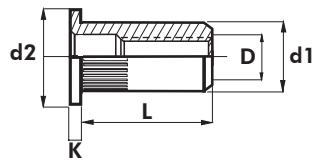

English	Español	Français	Deutsch	Portugues
Large head	Cabeza ancha	Tête large	Grosskopf	Cabeça larga
Grooved	Ranurada	Rainure	Mit schaffrändelung	Ranhurada
Open end	Fond abierto	Fond ouvert	Offen	Fundo aberto
Stainless Steel A2*	Acero inoxidable A2*	Inox A2*	Edelstahl A2*	Inox A2*

\*AISI 304

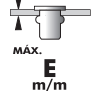

D	 MAX. E m/m	L Nominal m/m	d1 Ø m/m	d2 Ø m/m	K m/m		Part No./Ref.
M 4	0,50 - 2,00	9,50	5,95	9,00	1,00	6,10	0373104006
M 5	0,50 - 3,00	12,00	6,95	10,00	1,00	7,10	0373105007
	3,00 - 4,50	13,50					0373115007
M 6	0,50 - 3,00	14,50	8,95	13,00	1,50	9,10	0373106009
M 8	0,50 - 3,00	16,50	10,95	16,00	1,50	11,10	0373108011
	3,00 - 5,50	18,50					0373118011
M10	1,00 - 3,50	19,00	12,95	17,00	2,00	13,10	0373101013
	3,50 - 6,00	21,50					0373111013

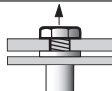
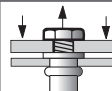
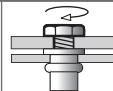
D	 Setting effort Fuerza para remachado	 Tensile Strength Threads Tracción	 Torque Testing Par de apriete
M 4	5600	9100	6,4
M 5	6800	15800	8,4
M 6	9000	23800	26,7
M 8	10600	40600	62,5
M10	11300	>49000	111,7

The total or partial reproduction of this document is prohibited. The figures showed in this catalogue are typical values and they could be changed as a result of the continuous improvement of products. Please, do not hesitate to contact us if you need an updated information. Queda prohibida la reproducción total o parcial de este documento. Los datos que aparecen en este catálogo son valores típicos y están sujetos a modificaciones como consecuencia de la mejora continua de los productos. Consúltenos si necesita información actualizada.