

BLIND RIVET GRIPMATE REMACHE GRIPMATE

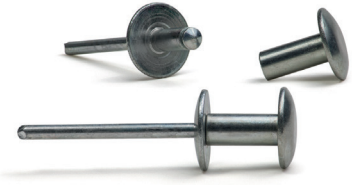



English	Español	Français	Deutsch	Portugues
Large head	Cabeza ancha	Tête large	Grosskopf	Cabeça larga
Body: Steel * zincplated A3 K ***	Cuerpo: Acero * cincado A3K ***	Corps: Acier * zingué A3K ***	Hülse: Acier * zingué A3K ***	Corpo: Acier * zingué A3K ***
Mandrel: Steel ** zincplated A1K ***	Vástago: Acero ** cincado A1K ***	Clou: Acier ** zingué A1K ***	Dorn: Stahl ** verzinkt A1K ***	Prego: Aço ** zincado A1K ***

* Steel /acero C8C DIN 1.0213

** Steel /acero DIN EN 10016-2 SAE 1010-1020-1030-1040

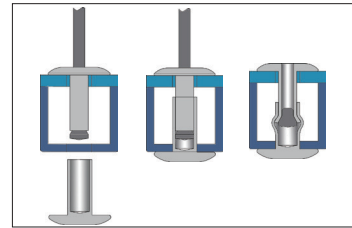
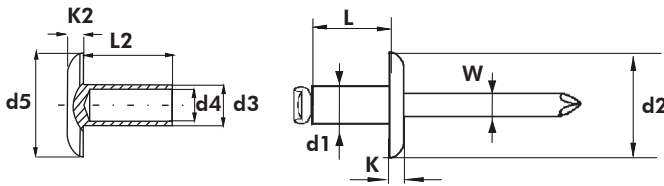
***Recubrimientos/Coatings according to ISO 4042

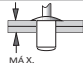

d1 Ø m/m	L Nominal m/m	 E m/m		d2 Ø m/m	K m/m	W m/m	Part No/Ref.
4,8	11,5	14,0 - 18,0	4,90	16,00	2,40	2,93	G1234004811
	14,5	19,0 - 22,0		16,00	2,40	2,93	G1234004814

Test according to / Ensayos realizados según EN ISO 14589

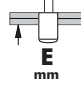
d1 Ø mm	L2 Nominal mm		k2 mm	d3 Ø mm	d4 Ø mm	d5 Ø mm	 E mm	Part No/Ref.
6,3	9,5	7,80	2,60	6,3	4,90	16,00	G12340063095	
	14,5							G12340063145

The total or partial reproduction of this document is prohibited. The figures showed in this catalogue are typical values and they could be changed as a result of the continuous improvement of products. Please, do not hesitate to contact us if you need an updated information. Queda prohibida la reproducción total o parcial de este documento. Los datos que aparecen en este catálogo son valores típicos y están sujetos a modificaciones como consecuencia de la mejora continua de los productos. Consúltenos si necesita información actualizada.