

HALF HEXAGON LARGE HEAD NUT

TUERCA SEMIHEXAGONAL ANCHA

INTERIOR HEXAGONAL / HEXAGON INTERIOR
 INTERIOR CILINDRICA / CYLINDRICAL INTERIOR



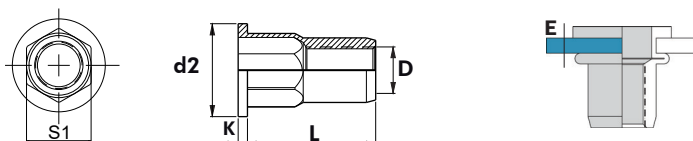

English	Español	Français	Deutsch	Portugues
Large head	Cabeza ancha	Tête large	Flachrundkopf	Cabeça larga
Half hexagon	Semihexagonal	Semi hexagonal	Teilesechskantschaft	Semi sextavada
Open end	Fondo abierto	Fond ouvert	Offen	Fundo aberto
Steel *	Acero *	Acier *	Stahl *	Aço *
Zincplated A3K	cincado A3K	zinguê A3K	verzinkt A3K	zincado A3K

*Steel /acero Qst 34.3 C8C D IN 1.0213



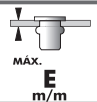

Interior hexagonal/ hexagon interior

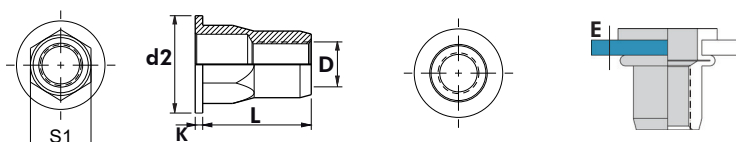
D	 MAX. E m/m	L Nominal m/m	s1 Ø m/m	d2 Ø m/m	K m/m		Part No/Ref.
M 6	0,50 - 3,00	14,50	8,95	13,00	1,50	9,10	0331106009
M 8	0,50 - 3,00	16,50	10,95	16,00	1,50	11,10	0331108011
M 12	1,00 - 4,00	25,00	15,95	23,00	2,00	16,10	0331101216

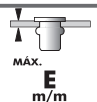

Interior cilíndrico/ cylindrical interior

D	 MAX. E m/m	L Nominal m/m	S1 Ø m/m	d2 Ø m/m	K m/m		Part No/Ref.
M 4	0,50 - 2,50	9,00	5,95	9,00	0,90	6,10	0334104006
M 5	0,50 - 3,00	12,50	6,95	10,00	1,00	7,10	0334105007
M 6	0,50 - 3,00	14,50	8,95	13,00	1,50	9,10	0334106009
M 10	0,80 - 3,00	20,00	12,95	19,00	2,00	13,10	0334101013
M12	1,00 - 4,00	25,00	15,95	23,00	2,20	16,10	G334101216

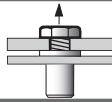
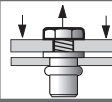
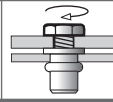
D		Setting effort Fuerza para remachado		Tensile Strength Threads Tracción		Torque Testing Par de apriete
M 4		3400		7900		4,8
M 5		7000		9800		6,5
M 6		7100		19100		22,0
M 8		9600		29800		40,0
M10		13400		36000		60,0
M12		17200		44000		115,0

The total or partial reproduction of this document is prohibited. The figures showed in this catalogue are typical values and they could be changed as a result of the continuous improvement of products. Please, do not hesitate to contact us if you need an updated information. Queda prohibida la reproducción total o parcial de este documento. Los datos que aparecen en este catálogo son valores típicos y están sujetos a modificaciones como consecuencia de la mejora continua de los productos. Consúltenos si necesita información actualizada.